

VIDEO DOOR PHONE

Model No. APV-4PM

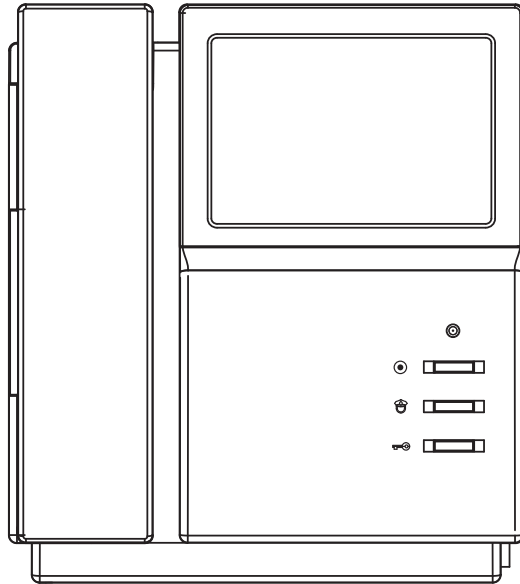

COMMAX Co.,Ltd.

- Thank you for purchasing our COMMAX product.
- Please carefully read this User's Guide (in particular, precautions for safety) before using the product and follow the instructions to use your product exactly.
- The company is not responsible for any safety accidents caused in abnormal operation of the product.

Table of Contents

Warnings and caution	2
Features & Specifications	4
Part Name & Function	5
Multi Entry Panel Calling	6
Sub unit calling (Intercommunication)	6
Guard station or external area calling	6
Call/ Talk duration	7
Setting In-House unit as a Master and Sub Unite	7
Chime sound	8
Changing and initialization of the password	8
Opening the entrance of a Multi-entry Panel With Password	9
Wiring	10
System diagram	11

Warnings and caution

◎ Make sure to follow the instructions to prevent any danger or property losses.



Warning
Death or serious injury is expected.

- It indicates prohibition.
- It indicates prohibition of disassembly.
- It indicates prohibition of contact.
- It indicates dos and don'ts.
- It indicates that the plug should be pulled out from the socket.



Warning

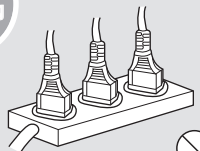

Do not put the plug in the socket simultaneously.
It may generate abnormal heat or cause a fire.

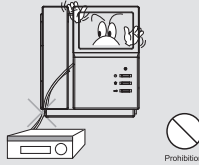

Do not connect to other products while in use.
It may cause breakdown.

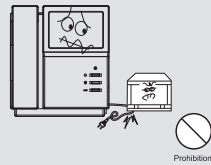

Do not forcibly bend the cord or put a heavy object on the product.
It may cause a fire.

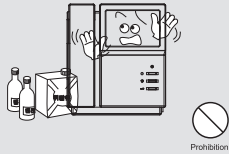

Do not use water, thinner or a detergent used to wash oil products when you wash the exterior.
Make sure to wash it by using a dry cloth to prevent any breakdown or electric shock.

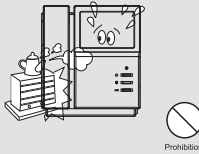

Do not install the product in a humid place.
It may cause an electric shock or a fire.

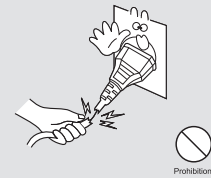

Do not forcibly pull out the cord from the socket.
If the cord is damaged, it may cause a fire or an electric shock.



Do not put the plug in the socket with a wet hand.
It may cause an electric shock.

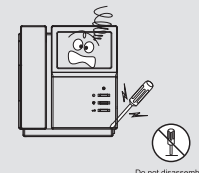

Do not disassemble, repair or modify the product.
It may cause a fire, an electric shock or an injury due to malfunction of the product.

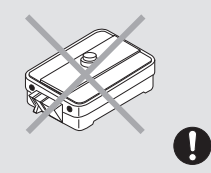

Do not use AC circuit breaker.
It may cause an electric shock.

Warnings and caution



Caution
An injury or property losses are expected

- It indicates prohibition.
- It indicates prohibition of disassembly.
- It indicates prohibition of contact.
- It indicates dos and don'ts.
- It indicates that the plug should be pulled out from the socket.



Caution

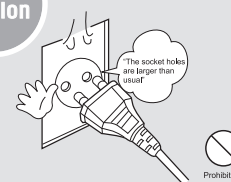

If the socket holes are larger than normal, do not put the plug.
It may cause an electric shock or a fire.

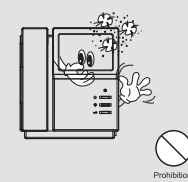

Make sure that dust or foreign substances are not gathered on the product.

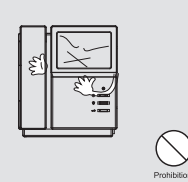

Make sure to prevent foreign substances from entering the product.
It may cause a breakdown.

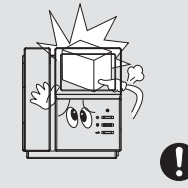

Do not put a heavy object on the product.
It may cause a breakdown.

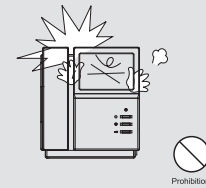

Do not disassemble or give an impact to the product.

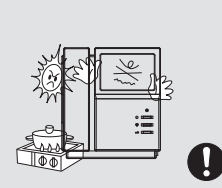

Avoid direct rays of the sun or heating devices at a time of installation.

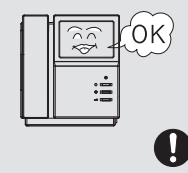

Install the product in a flat and stable place.
Otherwise, it may not function properly.

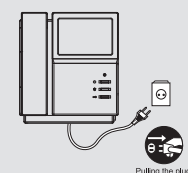

Pull the plug if the product is not used for a long time.

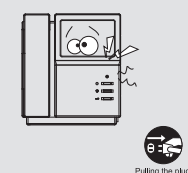

If the product generates strange sound, make sure to pull the plug immediately and contact Commax service center.

1. Features & Specifications

This is a DC type B/W Video phone.

It can add up to a maximum of 2 sub units in each residence and is a surface mount type video phone that connects to a guard station or external area. It's functions include Door release and intercommunicating

1) Features

- ① DC type B/W video phone
- ② When installing only 1 master unit, a power is supplied from a Floor distributor without an additional power supply.
- ③ Sub monitors need an extra power source.
- ④ 4" CRT Monitor
- ⑤ 3 buttons : "Guard station call", "door release" and "extension call".
- ⑥ COMMAX chime(Sol, Mi, Do) is the ring tone call sound from Multi Entry Panel
And there is a doorbell Ding-Dong sound from a individual door
- ⑦ Entrance release
- ⑧ 6 wires UTP Cable (CAT.5) including power source.

2. Specifications

ITEMS	APV-4PM
Wiring	Floor distributor: 6 wires (TALK2, DATA1, POWER1, VIDEO1, GND1)
Power Voltage	DC24V~28V / 5A (Master: Supplied from floor Distributor) (Slave: Extra power source is required)
Transmission Method	Full duplex
Screen Dimension	4" CRT
Power requirements	Stand by : 60mA/ Maximum operation :600mA
Distance range	Between Floor Distributor and In-house unit UTP (∅ 0.5) 50m

2. Parts names & Function

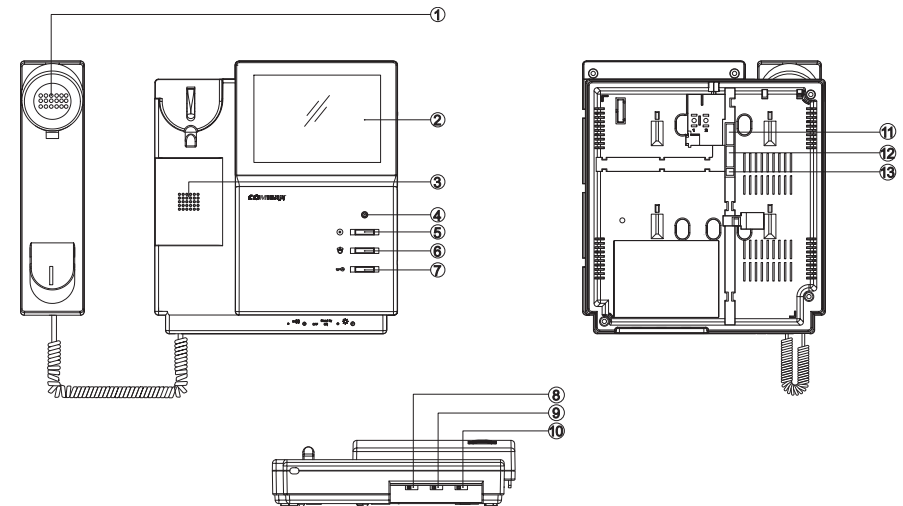

No.	Details	No.	Details
1	Handset	8	Call volume control
2	CRT Screen	9	Power switch
3	Speaker	10	Video brightness control
4	Power Lamp	11	Connecting terminal to Floor distributor
5	Extension call button	12	Connecting terminal to sub unit
6	Guard station call button	13	Connecting terminal to Audio type Door bell
7	Door release button		

- ♣ This is an in-house unit which is a B/W video phone.
Up to 4 residences are connectable with a single Floor distributor through a Building Distributor connected with the Multi Entry Panel.
Each residence can add 2 sub-units, which comes to 3 units in total including master unit.

3. Multi Entry Panel Calling

- ① When calling from the Multi-Entry Panel, you will hear the COMMAX chime and the image of the visitor will be shown on the screen
- ② Pick up the handset to initiate conversation.
- ③ When opening the door of the Multi Entry Panel during a conversation, press the “Door release” button and the entrance will open.
(The call conversation is ended right after the release of the door)
- ④ When conversation is over, hang up the handset.

4. Sub unit calling (Intercommunication)

- ① Pick up the handset and, press the “extension call button”, to call to the sub unit.
- ② When the sub unit responds, conversation occurs.
(calling both the Extension and Master unit is possible)
※ when calling to Guard station with another unit or while talking with other Extension, another in-house unit can not make a call.
- ③ while talking with another extension unit and an incoming call from the Multi-Entry panel arrives,
- ④ If this time, you have 30seconds to answer the call from the Multi-Entry panel by pressing the hook switch once on the extension unit(only one extension unit can have a conversation with Multi-Entry panel at a time)

5. Guard station or external area calling

- ① Pick up the handset and press the “Guard call” button to call the Guard Station.
- ② When the guard station responds, conversation can occurs.
* The Guard station unit does not have a calling function, only receiving)
* If the Guard unit is on the line with another residence or Multi entry unit, you will hear a busy tone)

6. Call/ Talk duration

This is applied to all calls and conversation.

- ① Calling time lasts for 30 second.
- ② Talking duration lasts for 60 second.

7. Setting In-House unit as a Master and Sub Unit

- This setting should be set by Multi entry panel which should be connected to channel 1
- when a single unit is installed, the setting should be set as a master unit.
in case more than 2 unit are installed one should be set as the master, and the rest should be set as slave unit
- The “Door Release” and “Extension” button on the unit run as a selection to master or slave in this mode

1) Setting Master

- ① Set the ID as “0” on Multi-Entry panel which should be connected to channel 1
- The default of all Multi Entry Panels is assigned to “0”.
- ② While picking up the handset of an in-house unit, press the “extension call” button and the “door release” button at the same time.
- ③ You can communicate with the Multi Entry Panel while the resident’s number is displayed on it.
- ④ When the “*** -> M” message is displayed on the Multi Entry Panel when you press the “Door Open” button on an in-house unit.
- ⑤ Then, register the ID of the shown residence, and press “” button to hear a sound of completion.
- ⑥ The registration is complete when you hang up the handset.
(Repeat this process for other residences)
- ⑦ Set the ID’ as “1” on the Multi-Entry panel after completing the registration

2) Setting the Sub-Unit

- ① Set the ID as “0” Multi-Entry panel which should be connected to channel 1
-The default of all Multi Entry Panels is assigned to “0”
- ② While picking up the handset of an in-house unit, press “extension call” button and the “door open” button at the same time.
- ③ You can communicate with Multi Entry Panel while the resident’s number displayed on it.
- ④ When the “*** -> S” message is displayed on the Multi Entry Panel when you press the “Extension call” button on the in-house unit.

- ⑤ Then, register the ID of the said residence, and press “

8. Chime sound

Chime will sound when calling an individual door bell with audio type.

9. Changing and initialization of the password

Note) The doors do not open by default password “1234”.
Only after changing default Password, can you use this function

1) Initialization for the password (only the password for the Master unit is initialized)

- ① Shut off master unit and turn it on again while holding the “extension call” button and “Door release” button at the same time for 3 seconds at the same time.
- ② The password will initialize to “1234” when the blink of LED stops.

Note : Default password : 1234

2) Changing Resident Password(From Multi Entry Panel)

- ① Hold “Residence Number” and “

10. Opening the entrance of a Multi-entry Panel With Password

Note) The doors do not open by default password “1234”.
Only after changing default Password, can you use this function

1) Open the entrance with resident password

- ① Press resident number” and “

2) Open the entrance with Building password

- ① Enter “9900” and “

8



11. Wiring

1) Wiring method

- Please pay attention to the polarity of the wires.
Units will not work properly when mis-wired
- * Use UTP(CAT.5) cable and be careful to match the color of the wires shown to the left
- The Power of the Master unit supplied from the Floor distributor without an additional power supply, but additional sub units are needed separate a power source.
(There is no power line connection between Mast unit and Sub units)

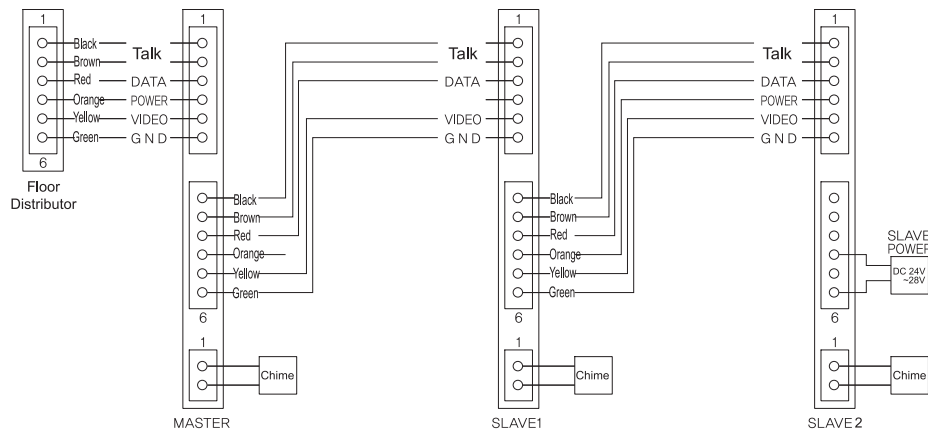

CCU-FS		APV-4PM	
1	Black	Stripe orange	Black
2	Brown	Orange	Brown
3	Red	Stripe green	Red
4	Orange	Green	Orange
5	Yellow	Stripe Blue	Yellow
6	Green	Blue	Green

UTP(CAT.5)
(TWIST PAIR)



12. System diagram

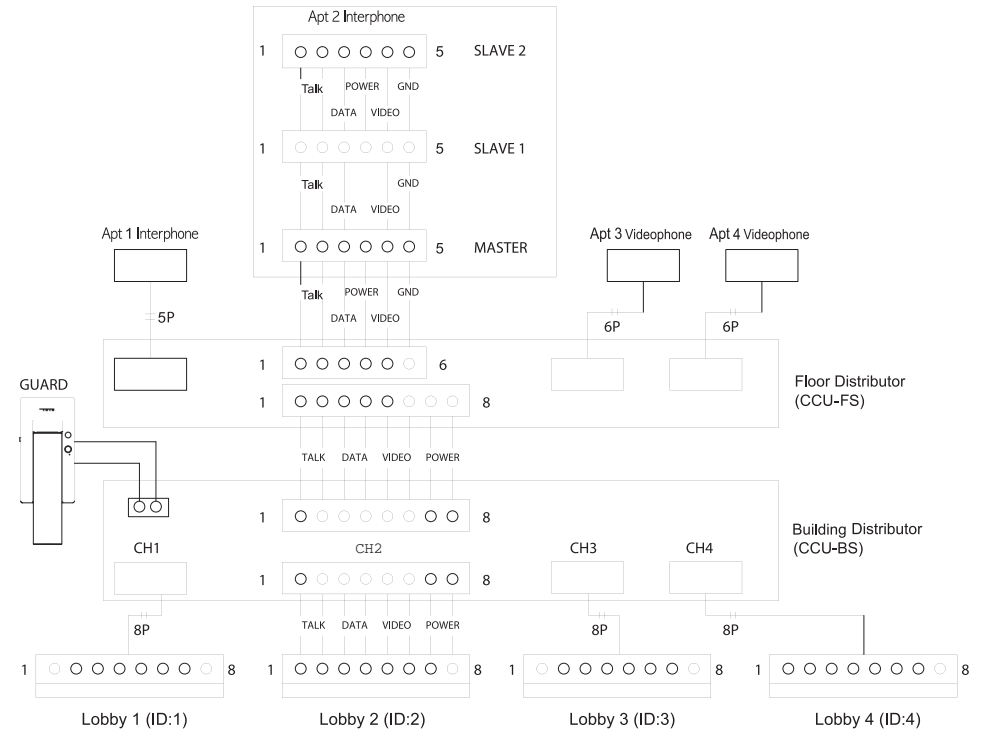



COMMAX Co.,Ltd.

a513-11, Sangdaewon-dong, Jungwon-gu, Seongnam-si, Gyeonggi-do, Korea

Int'l Business Dept. : Tel.; +82-31-7393-540~550 Fax.; +82-31-745-2133

Web site : www.commax.com

Printed In Korea/ 2007.10